

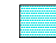

LIST OF POINTS							
SI No.	MANHOLE ID	DRAIN Closed(C) /Open(O)	MSL LEVEL			DRAIN DIMENSIONS	
			Drain Top(m)	Invert (m)	Road Edge (m)	Width (m)	Depth (m)
1	A1	C	4.029	3.079	4.031	0.990	0.730
2	A2	C	4.280	3.150	4.287	0.980	0.890
3	B1	C	3.994	3.414	3.866	0.640	0.450
4	B2	C	3.886	3.146	3.967	0.780	0.560
5	B3	C	4.146	3.056	4.057	0.920	0.910
6	B4	C	3.961	3.121	4.001	0.790	0.710
7	B5	C	4.085	—	4.066	—	—
8	B6	C	4.356	3.626	4.299	0.780	0.590
9	B7	C	3.979	2.959	3.959	0.820	0.840
10	B8	C	4.149	—	4.111	—	—
11	B9	C	4.032	2.672	3.893	0.840	0.980
12	B10	C	3.994	2.574	3.968	0.920	1.140
13	B11	C	3.962	2.982	4.028	0.790	0.840
14	B12	C	3.957	2.747	3.975	0.780	0.930
15	B13	C	4.121	3.011	3.886	0.760	0.970
16	B14	C	4.113	3.063	3.909	0.780	0.570
17	B15	C	4.111	2.981	3.915	0.780	0.850
18	B16	C	4.049	3.369	4.085	0.720	0.540
19	B17	C	4.731	3.801	4.553	0.780	0.670
20	B18	C	4.853	4.243	4.801	0.720	0.420
21	B21	C	4.079	3.239	4.059	0.820	0.700
22	B20	C	4.317	3.497	4.170	0.720	0.660
23	B19	C	4.104	3.354	3.931	0.720	0.630
24	B22	C	4.061	3.151	4.078	0.790	0.750
25	B23	C	3.991	3.041	3.883	0.740	0.810
26	B24	C	4.045	3.415	3.937	0.720	0.450
27	B25	C	4.006	2.816	4.020	0.710	0.910
28	B26	C	3.876	2.896	3.955	0.810	0.740
29	B27	C	3.927	2.807	3.927	0.760	0.810
30	C1	C	4.575	2.865	4.436	1.210	1.290
31	C2	C	4.241	3.261	4.018	0.740	0.720
32	C3	C	4.133	2.923	4.029	0.880	0.730
33	C4	C	4.222	2.882	4.168	1.060	1.080
34	C5	C	4.323	3.113	4.249	1.040	0.990
35	C6	C	4.416	3.106	4.339	1.100	0.950
36	C7	C	4.294	3.194	4.144	0.860	0.890
37	C8	C	4.316	3.776	4.232	0.720	0.410
38	C9	C	4.083	—	4.046	—	—
39	C10	C	4.186	3.056	4.102	0.690	0.840
40	C11	C	4.172	3.152	4.021	0.740	0.760
41	C12	C	4.216	3.266	4.051	0.680	0.840
42	C13	C	4.213	3.333	4.183	0.720	0.720
43	C14	C	4.895	3.365	4.596	0.790	1.360
44	C15	C	4.246	3.186	3.941	0.810	0.800
45	C16	C	4.295	3.195	4.167	0.840	0.880
46	C17	C	3.967	3.157	3.910	0.840	0.650
47	C18	C	4.144	2.834	3.928	0.880	0.900
48	D1	C	4.455	2.845	4.335	1.100	1.300
49	D2	C	4.133	2.653	3.965	0.980	1.140
50	D3	C	4.365	3.035	4.210	0.930	0.990
51	D4	C	5.488	0.000	5.243	0.000	0.000
52	D5	C	4.295	3.515	4.331	0.890	0.540
53	D6	C	4.437	3.757	4.280	0.780	0.460
54	D7	C	4.144	3.094	4.025	1.080	0.840
55	D8	C	4.140	3.200	4.042	0.980	0.800
56	E1	C	3.478	2.547	3.416	0.901	0.519
57	E2	C	3.615	2.763	3.597	0.815	0.442
58	E3	C	3.614	2.759	3.543	0.812	0.640
59	E4	C	3.785	2.735	3.699	0.923	0.865
60	E5	C	3.618	2.586	3.520	0.915	0.817
61	E6	C	3.834	2.869	4.006	0.815	0.787
62	E7	C	3.763	2.818	3.663	0.905	0.720
63	E8	C	3.793	2.842	3.667	0.815	0.736
64	E9	C	3.840	2.889	—	0.852	0.751
65	E10	C	3.397	2.546	3.392	0.801	0.436
66	E11	C	3.630	2.815	3.630	0.751	0.410
67	E12	C	3.635	2.809	3.655	0.851	0.401

LEGEND

 Drain Outlet

 Drain With Reverse Gradient

"—" : Manhole's Inside not Accessible

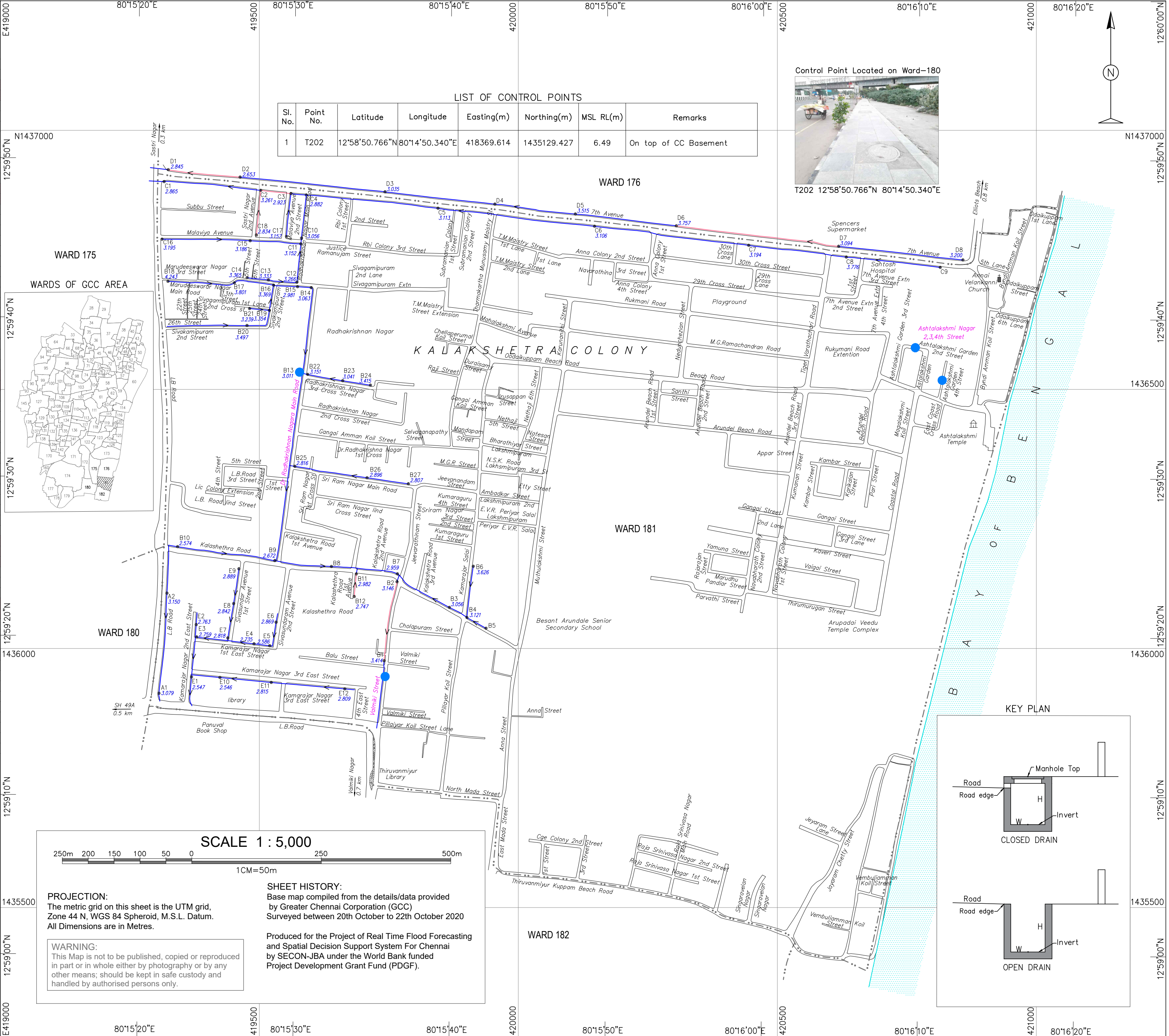
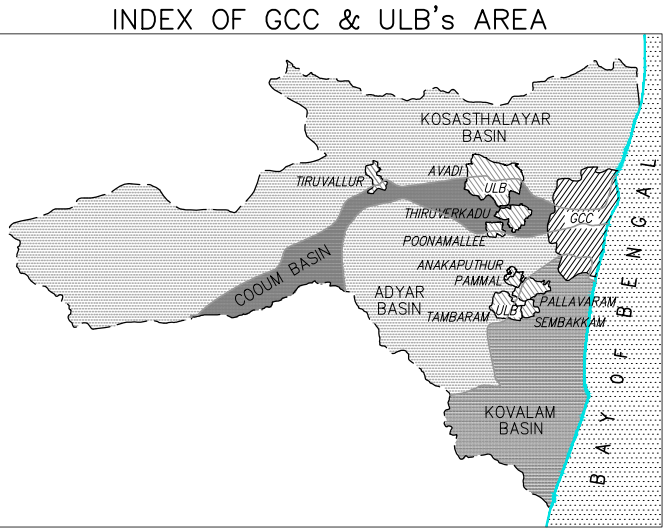

Roads: main; others; mud. Cart track.

Temple. Chhatri. Shrine. Mosque. Idgah. Tomb. Church.

Railways: broad gauge with station; bridge; metro.

Boundary: state; district; taluk.

Boundary: CMA; zone; ward.

Roads: without drain; with onside drain; with both side drain.

Road with reverse gradient drain.

Spaced names: locality; village.

Drains: stormwater; feeder with flow direction. Invert level.

Canal. Outlet. Inundated area by privious flood,.

Bridge with piers. Culvert. Flyover. Subway. Sewage line.

River: dry with water channel; with island & rocks. Tidal river.

Streams: perennial; non perennial; Single line: defined. Tank.

Rain water Harvesting. Stormwater pumping station.

CLIENT

FUNDED BY

PROJECT

TITLE

PROJECT CONSULTANTS

SHEET No. 33 OF 114

GREATER CHENNAI CORPORATION (GCC)

REPRESENTING COMMISSIONERATE OF REVENUE ADMINISTRATION AND DISASTER MANAGEMENT

PROJECT DEVELOPMENT GRANT FUND (PDGF)

(Managed by Tamil Nadu Urban Infrastructure Financial Services Limited)

PLANNING, SETTING UP AND OPERATIONALIZING REAL TIME FLOOD FORECASTING SPATIAL DECISION SUPPORT SYSTEM FOR CHENNAI

BASE MAP - STORM WATER DRAIN

WARD No. 181, ZONE XIII - ADYAR NAGAR

SECON - JBA Consulting

(India) (U.K.) JV

SCALE 1:5000

DRAWING No.

CFM/SWD/WARD-33

REV. 0

